

# Plastic Fittings

## F-3140-80 Barbed Union

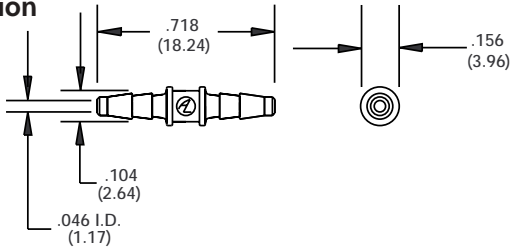

Barbed ports for  $\frac{1}{16}$ " I.D. flexible tubing.  
Material: Nylon - Black or White  
Polypropylene - Gray

## F-3144-80 Barbed Elbow

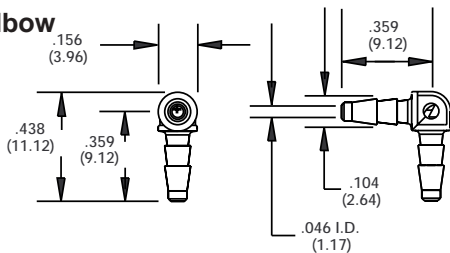

Barbed ports for  $\frac{1}{16}$ " I.D. flexible tubing.  
Material: Nylon - Black or White  
Polypropylene - Gray

## F-3145-80 Barbed Tee

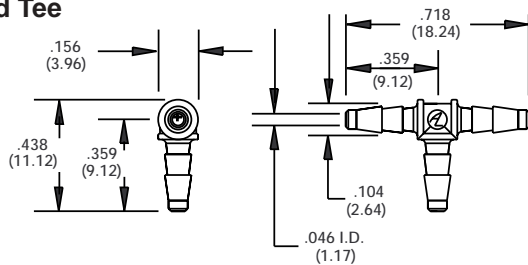

Barbed ports for  $\frac{1}{16}$ " I.D. flexible tubing.  
Material: Nylon - Black or White  
Polypropylene - Gray

## F-3146-80 Barbed Cross

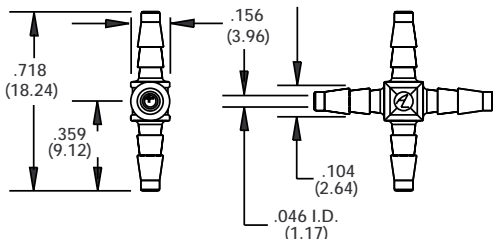

Barbed ports for  $\frac{1}{16}$ " I.D. flexible tubing.  
Material: Nylon - Black or White  
Polypropylene - Gray

( ) = Metric Dimensions

Please Read Warranty on Page 11

## F-3140-85 Barbed Union

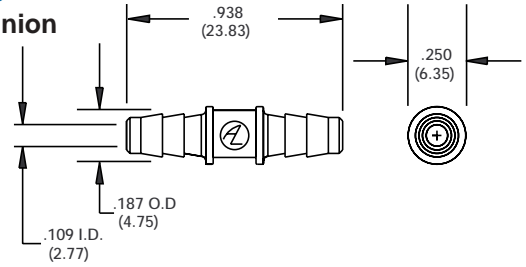

Barbed ports for  $\frac{1}{8}$ " I.D. flexible tubing.  
Material: Nylon - Black or White  
Polypropylene - Gray

## F-3144-85 Barbed Elbow

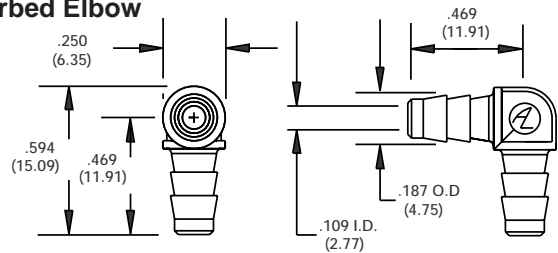

Barbed ports for  $\frac{1}{8}$ " I.D. flexible tubing.  
Material: Nylon - Black or White  
Polypropylene - Gray

## F-3145-85 Barbed Tee

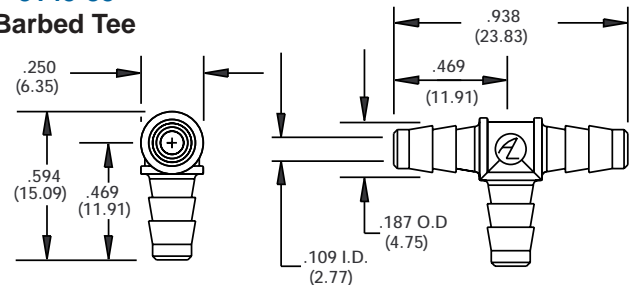

Barbed ports for  $\frac{1}{8}$ " I.D. flexible tubing.  
Material: Nylon - Black or White  
Polypropylene - Gray

## F-3146-85 Barbed Cross

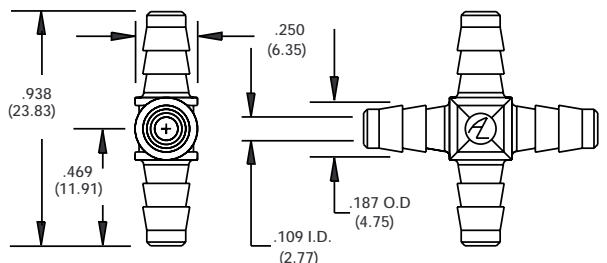

Barbed ports for  $\frac{1}{8}$ " I.D. flexible tubing.  
Material: Nylon - Black or White  
Polypropylene - Gray

( ) = Metric Dimensions

Check Chemical Comptability of Polysulfone.